

## PRODUCT SPECIFICATIONS

### TD-3448: 34 x 48 Trench Drain Shower Pan



#### STANDARD FEATURES

- Solid one-piece cast marble
- Durable gel coat surface
- Pre-leveled-rests on subfloor
- Extremely sanitary
- Will not mold or mildew
- Easy to install
- Maintenance-free
- Manufactured in the U.S.A.
- Trench drain with removable cover for easy cleaning
- Recommended: Shower Pan Protective Covers

#### APPLICATIONS

- Hospitality | Multifamily | Senior Living | Student Housing | Military Housing

#### ITEM NUMBER

- TD-3448-OS-SF

#### TECHNICAL SPECIFICATIONS

|                          |   |
|--------------------------|---|
| MODEL                    | Trench Drain  |
| PAN SIZE                 | 34" x 48"   |
| MATERIAL                 | Cast Marble   |
| FLOOR PATTERN            | Traditional   |
| FINISH                   | Matte, Textured, Non-Slip   |
| BACKWALL                 | 48"   |
| SIDE WALLS               | 34"   |
| DRAIN LOCATION           | Offset - (specify left or right)                                  |
| CENTER OF DRAIN MEASURES | 14 3/16" from backwall, 4" from side wall                         |
| DIMENSIONS               | NOTE: Finished product dimensions may vary +/- 1/8" from drawings |
| DRAIN OPENING            | 3 1/4"  |
| TRENCH WIDTH             | 4 3/4"  |
| DRAIN COVER              | ~28"  |
| FLANGE                   | 1" on side and backwalls - attached at factory                    |
| FRONT CURB               | Integral, 3" w x 3" h   |
| WEIGHT                   | ~ 254#  |
| STANDARD                 | Mincey Classic™   |
| SLOPE                    | Pan is sloped toward the drain at 2%                              |
| CSI NUMBER               | 22 42 23  |



#### CONTACT OUR SALES STAFF

M-F: 8:00 am - 5:00 pm  
Eastern

770-532-0451



#### WE'RE HERE TO HELP

Request a product sample, color sample or get a quote.

[sales@minceymarble.com](mailto:sales@minceymarble.com)  
[samples@minceymarble.com](mailto:samples@minceymarble.com)

PRODUCT SPECIFICATIONS

TD-3448: 34 x 48 Trench Drain Shower Pan



| COLORS     |      |
|------------|------|
| ALMOND     | 7800 |
| BONE       | 7670 |
| CREAM      | 7400 |
| IVORY      | 7300 |
| WHITE      | 2250 |
| LIGHT GRAY | 7256 |
| PUTTY      | 7000 |

| SPECIAL NOTES  |  |
|--|--|
| <ul style="list-style-type: none"><li>• Standards and Ratings:</li><li>• CSA B45-5/IAPMO Z124-2022</li><li>• MAS Certified Green. Compliant with ANSI/BIFMA X7.1 Standard</li><li>• ANSI A137.1 (average rating of 0.65)</li><li>• ANSI/NFSI B101.3 (average rating of 0.66)</li><li>• Suggested Drains:</li><li>• Sioux Chief Mfg. model: 825-2P – PVC</li><li>• Oatey part number: 42045 – PVC</li><li>• Oatey part number: 42150 – Brass</li><li>• NOTE: Finished product dimensions may vary +/- 1/8" from drawings</li><li>• NOTE: Drain is not included with pan</li></ul> |  |

TD-3448-OS/SF-L

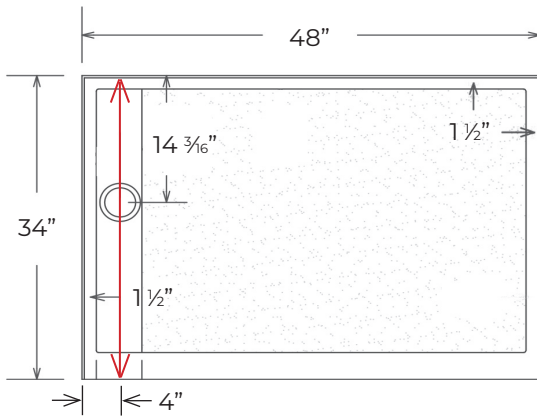

Finished product dimensions may vary by +/- 1/8" from drawings.

TD-3448-OS/SF-R

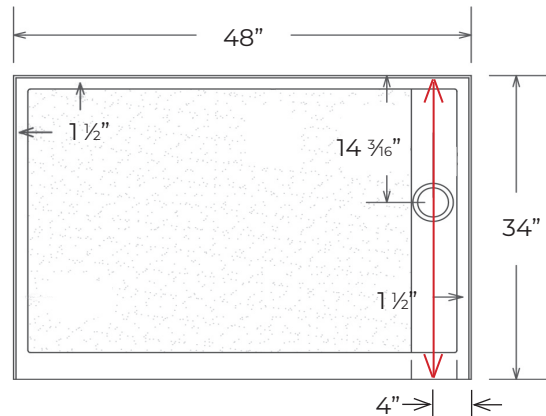

Finished product dimensions may vary by +/- 1/8" from drawings.

1" Flange Attached at Factory on Back & Sides

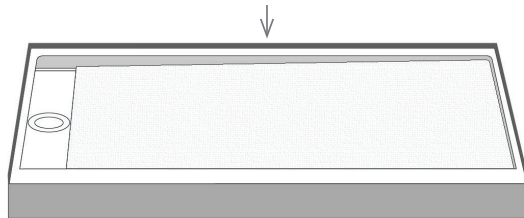

Integral Curb 3" Tall

Left Hand Drain Shown. Left & Right Hand Drain Available.

Drain Cover Options

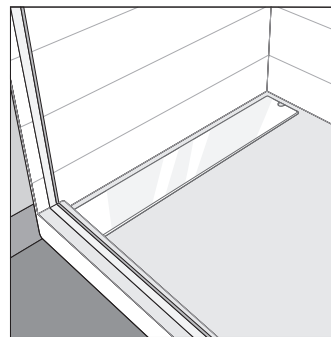

Solid

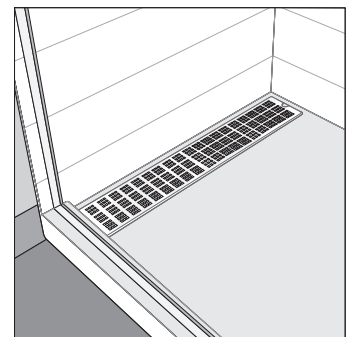

Decorative

Drain Detail:

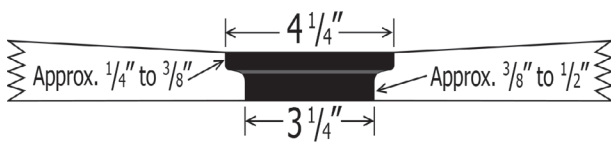

For an additional charge, Powder Coating options are available. Please contact our sales associates for more information.

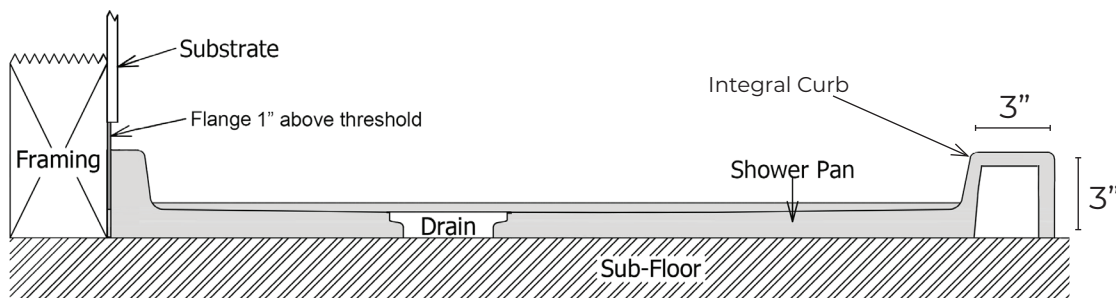

REV: 11.03.21