

PRODUCT SPECIFICATIONS

SP-3738: 37 x 38 Center Drain Pan



STANDARD FEATURES

- Solid one - piece construction
- Abrasion resistant gel coat surface
- Seamless
- Pre-leveled - rests on sub floor
- Extremely sanitary
- Will not mold or mildew
- Easy to install
- Maintenance free
- Manufactured in the U.S.A.

ITEM NUMBER

- SP-3738-C-IF

TECHNICAL SPECIFICATIONS

MODEL Center Drain Pan

PAN SIZE 37" x 38"

FLOOR PATTERN Traditional

FINISH Matte, Textured, Non-Slip

BACKWALL 37 7/8"

SIDE WALLS 36 7/8"

DRAIN LOCATION Center

CENTER OF DRAIN MEASURES 18 1/2" from backwall, 18 7/8" from side wall

DIMENSIONS NOTE: Finished product dimensions may vary +/- 1/8" from drawings

DRAIN OPENING 3 1/4"

FRONT CURB Integral - 3" w x 4" h

FLANGE 1" on side and backwalls - attached at factory

WEIGHT ~ 141#

STANDARD Mincey Classic™

CSI NUMBER 22 42 23

COLORS

ALMOND 7800

BONE 7670

CREAM 7400

IVORY 7300

WHITE 2250

LIGHT GRAY 7256



CONTACT OUR SALES STAFF

M-F: 8:00 am - 5:00 pm
Eastern

770-532-0451



WE'RE HERE TO HELP

Request a product sample, color
sample or get a quote.

sales@minceymarble.com
samples@minceymarble.com

PUTTY

7000

SPECIAL NOTES

- Standards and Ratings:
- CSA B45-5/IAPMO Z124-2011
- MAS Certified Green. Compliant with ANSI/BIFMA X7.1 Standard
- ANSI A137.1 (average rating of 0.65)
- ANSI A326.3 (average rating of 0.72)
- ANSI/NFSA B101.3 (average rating of 0.66)
- Suggested Drains:
- Sioux Chief Mfg. model: 825-2P – PVC
- Oatey part number: 42045 – PVC
- Oatey part number: 42150 – Brass
- Kohler model: K9132 – Stainless Steel
- NOTE: Finished product dimensions may vary +/- 1/8" from drawings
- NOTE: Drain is not included with pan

SP-3738-C-IF

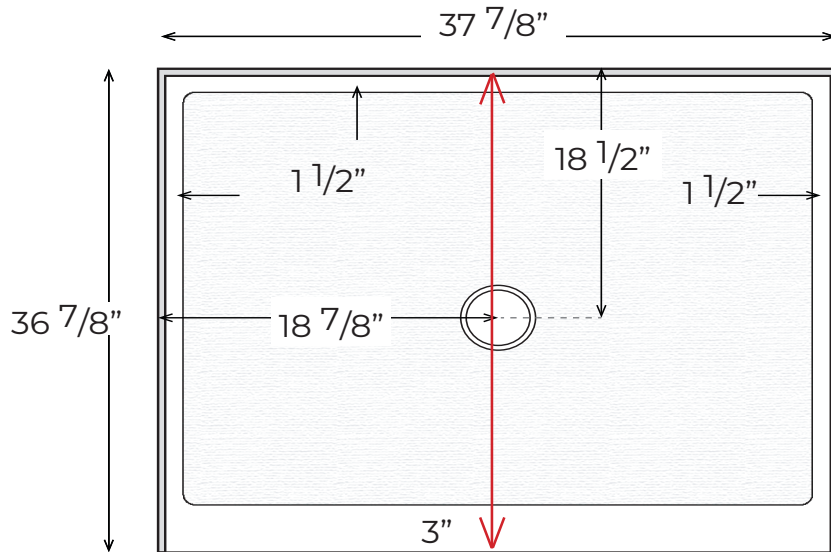

Finished product dimensions may vary by +/- 1/8" from drawings.

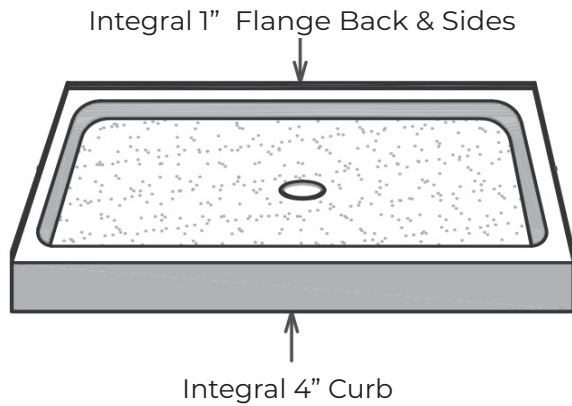

Drain Detail:

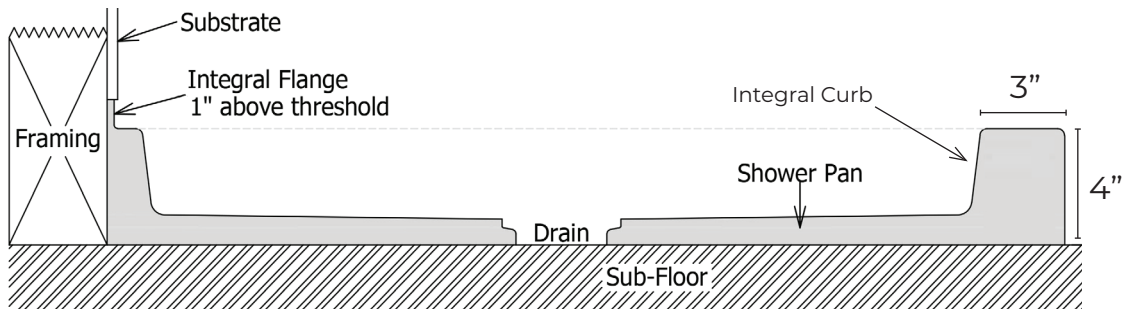
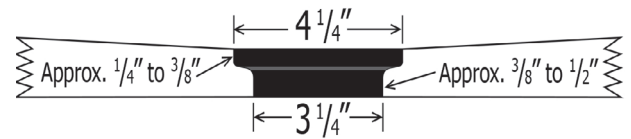

REV: 11.04.21