



## Installation Instructions for Mincey Marble's Shower Pans

### CONTENTS:

- Pre-installation checklist
- Standard installation
- Fire-rated installation

**ATTENTION:** If you are installing a custom pan with a separate curb, please see our custom pan installation instructions.

These installation instructions can be applied to any of the following Mincey shower pans: standard rectangle, square, curved front, neo-angle, transfer, walk-in and trench drain. **Drawings not to scale.**

All shower pans rest on sub-floors, not finished floors. Mincey's cast marble shower pans have been checked and leveled before leaving the production plant. They have been custom designed to drain properly if installed on a level surface. Some floors are not level. If the floor is out of level, you must either float the floor with mortar or some other suitable material **or** place plastic shims eight inches apart in all directions before setting the pan. The pans may not drain properly if installed in an out of level condition.

**DO NOT** use the leak-proof fiberglass flanges to lift or handle the pan. They are not handles and it is critical that they are not damaged or broken in any way during installation. They ensure the pan will not leak in the event there is a drain problem and water overflows the basin. They also prevent water from getting behind the wall.

**IMPORTANT NOTE:** DO NOT lift or handle pan with the attached fiberglass flange.

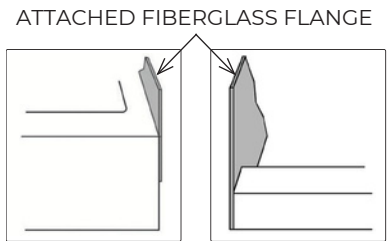

### STANDARD PAN INSTALLATION:

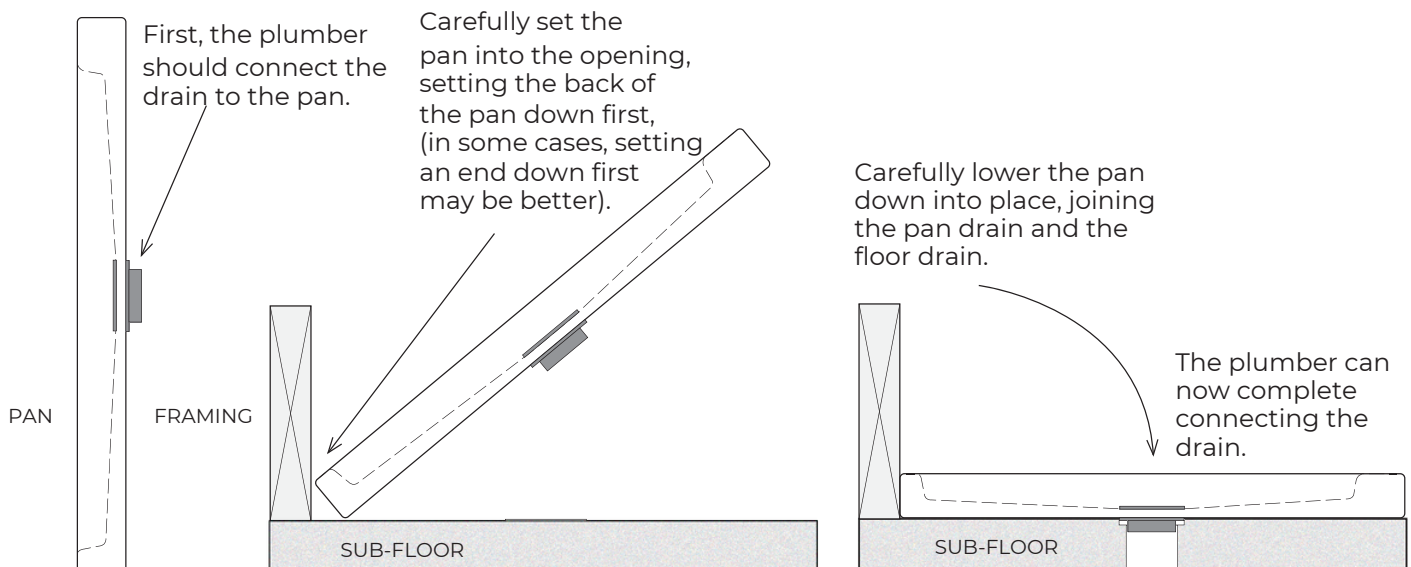

Substrate material (sheetrock, etc.) should not be installed until after the plumber has connected the plumbing to the pan.

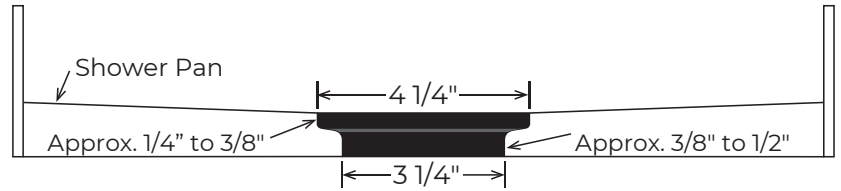

After setting the pan in place, you must check it on all four corners and diagonally in each direction for level. Shim all necessary areas to level the pan to make sure it does not move or rock at all.

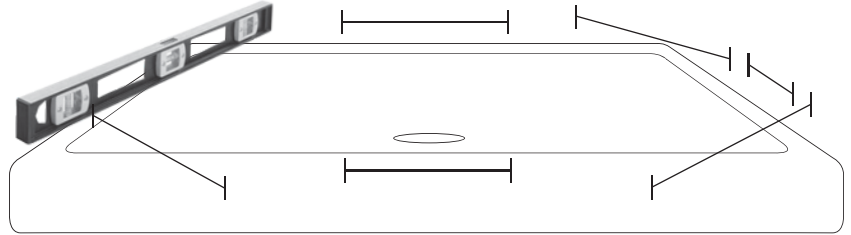

After the plumber has connected the drain, the substrate material (sheetrock, etc.) is ready to be installed. The substrate material should stop approximately 1/4" above the flange of the pan. See the diagrams below.

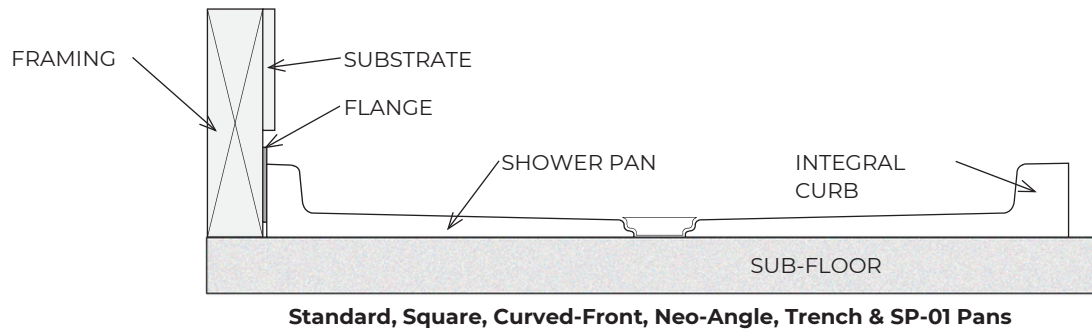

**NOTE:** When installing a walk-in pan, the pan is to be installed after the side and back walls are framed. After carefully placing the pan, the studs can be placed around the angles, walls, and entrance to the shower.

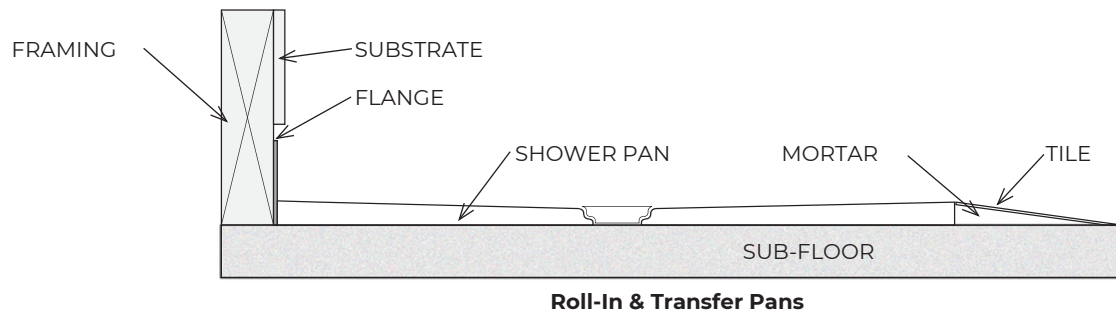

**NOTE:** Mincey roll-in & transfer pans do not come with a ramp. Your flooring installer will be able to tile up to the entrance of the shower pan following ADA guidelines, creating a ramp for the pan.

To complete the shower pan installation, install the shower drain cover.

## **FIRE RATED PAN INSTALLATION**

Begin with installing the first layer of fire-rated substrate. Then, the preferred method is to install a second layer of fire-rated substrate, stopping just above the fiberglass flange. The second layer can be installed before or after the shower pan is in place. The second layer of substrate will allow the shower panels to be installed from the surface of the pan upward without the shower panels bowing out.

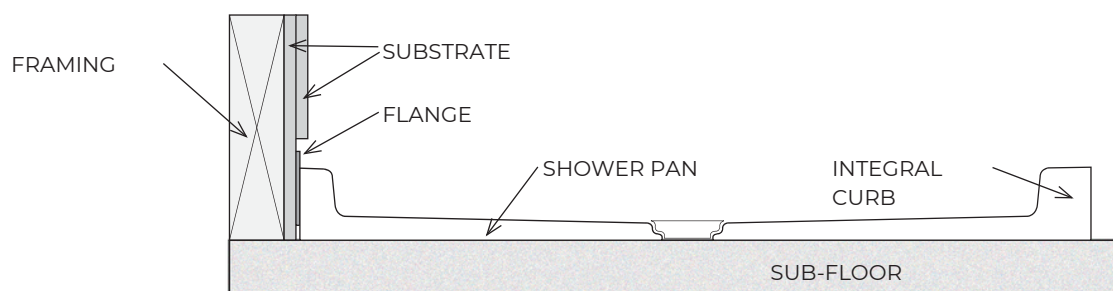

**Fire-Rated Substrate Installation**

When following fire-rated requirements, the substrate must be installed all the way to the sub-floor. When the shower panels are installed, they must extend over the attached flange all the way to the shower pan floor. If only one piece of substrate is used, the shower panel will bow out at the bottom to cover the flange. (See diagrams below)

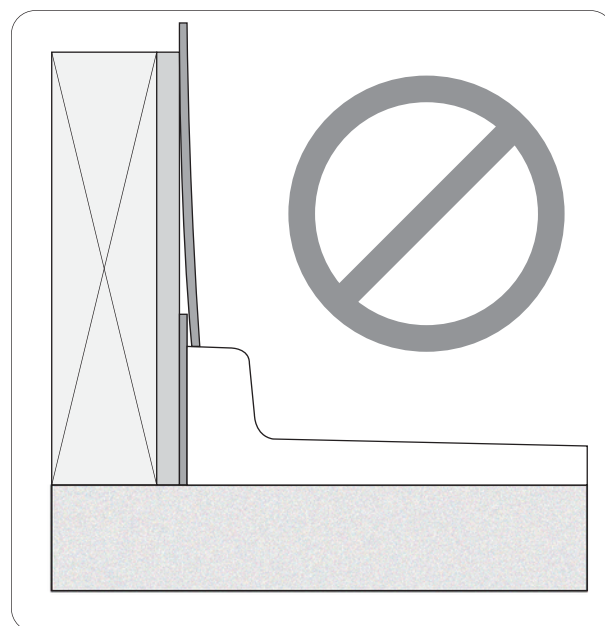
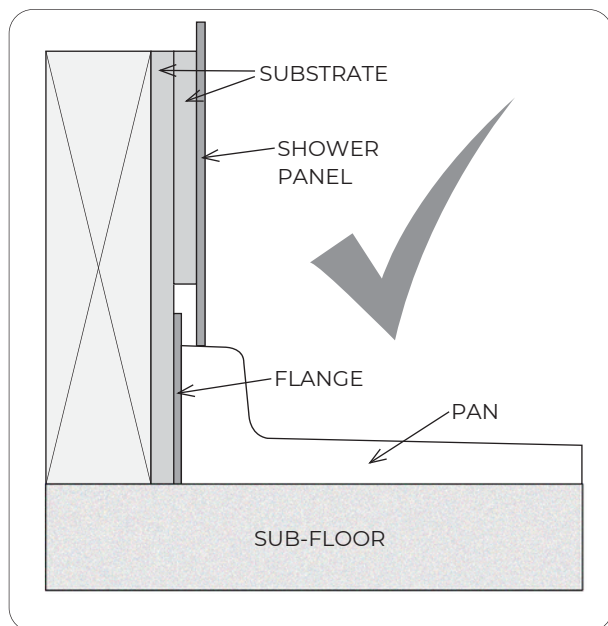

To complete the shower pan installation, install the shower drain cover.